

Fixing the support to the cabinet side

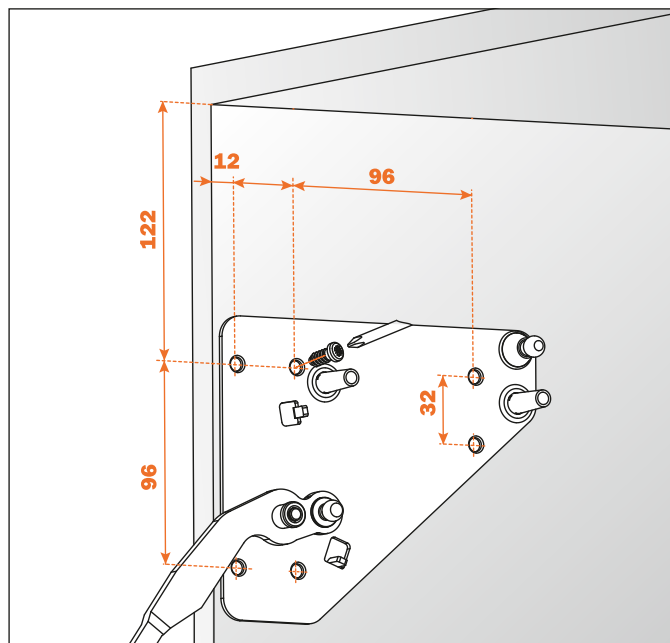

Deploying the piston

Carefully press each end of the piston securely onto the pins on the bracket and lifting arm, ensuring that the body of the piston is uppermost.

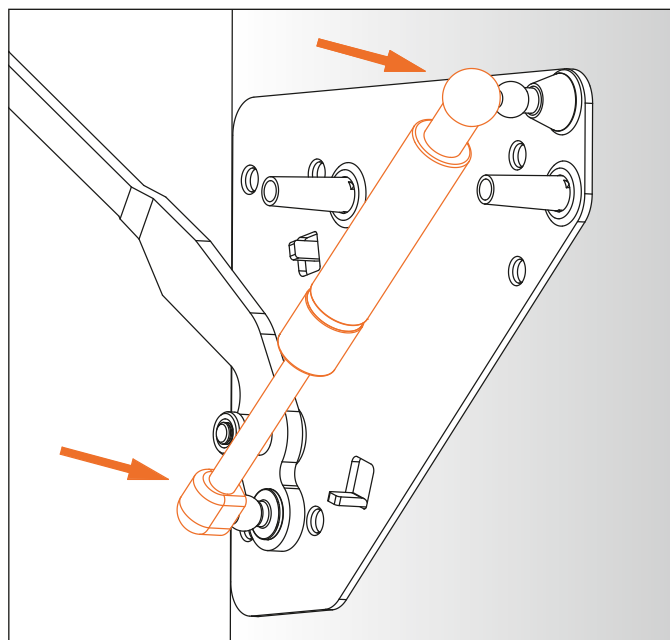

Installing the Smove

We suggest:

DOOFSNG for doors up to 6 kg
DOOLSNG for doors over 6 kg

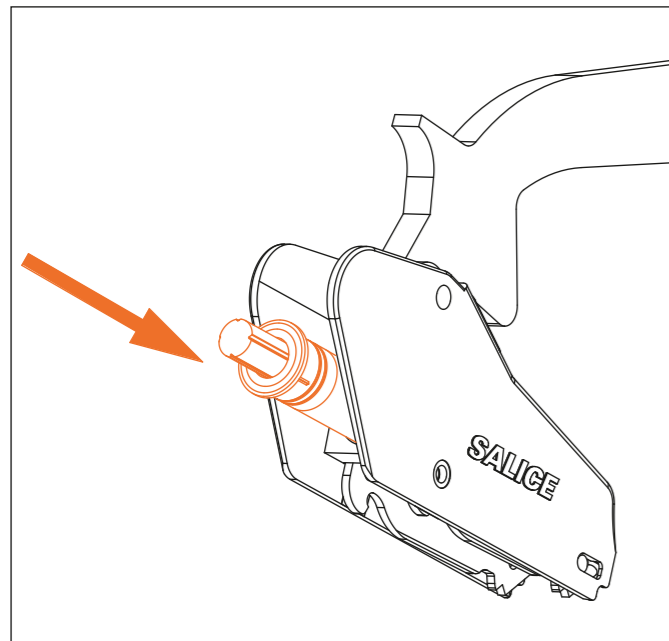

Drilling pattern for the upper wooden door

Available fixing systems for the hinge cup:

- A** = wood screw fixing, 48x6 mm drilling
- P** = wood screw fixing, 45x9.5 mm drilling
- U** = wood screw fixing, 52x5.5 mm drilling
- B** = dowel fixing, 48x6 mm drilling
- R** = dowel fixing, 45x9.5 mm drilling
- W** = dowel fixing, 52x5.5 mm drilling
- 6** = Rapido fixing, 48x6 mm drilling
- 7** = Rapido fixing, 45x9.5 mm drilling
- 2** = Rapido fixing, 52x5.5 mm drilling

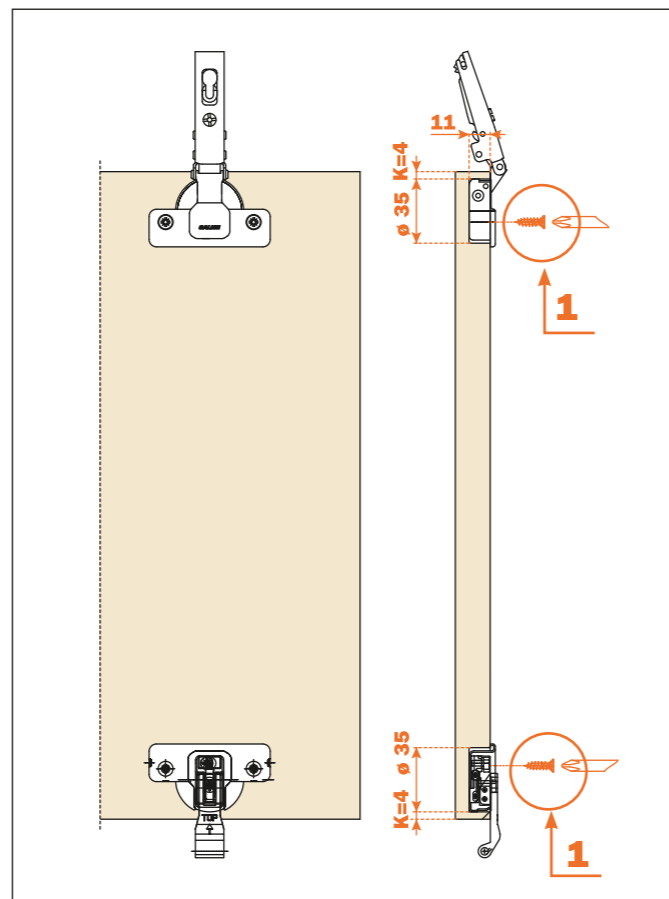
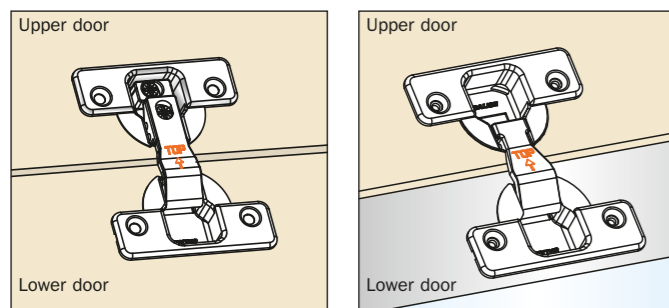

Drilling pattern for the upper alu-framed door - width min. 17 mm, max. 24 mm

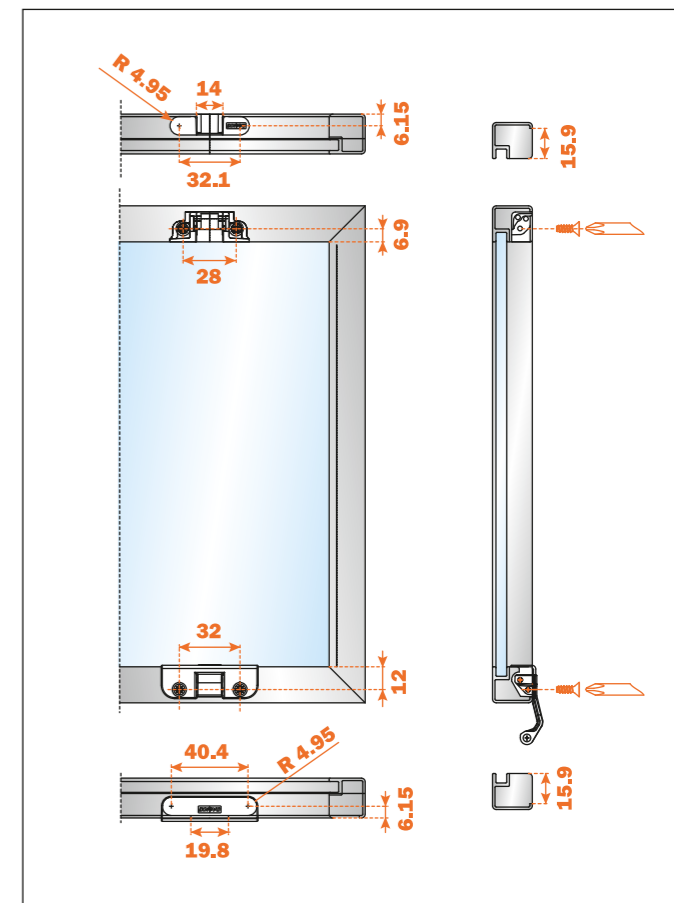
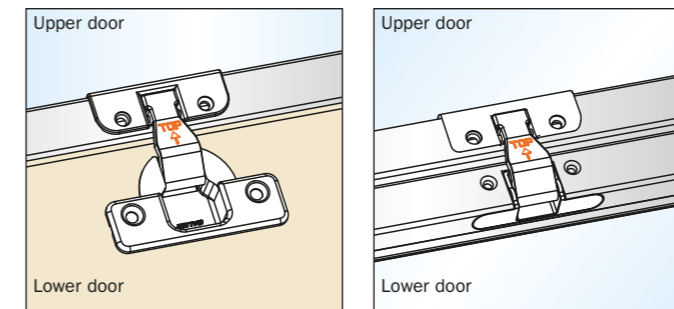

Drilling pattern for the upper alu-framed door - width min. 45 mm

Available fixing systems for the hinge cup:

- A** = woodscrew fixing, 48x6 mm drilling
- P** = woodscrew fixing, 45x9.5 mm drilling
- U** = woodscrew fixing, 52x5.5 mm drilling

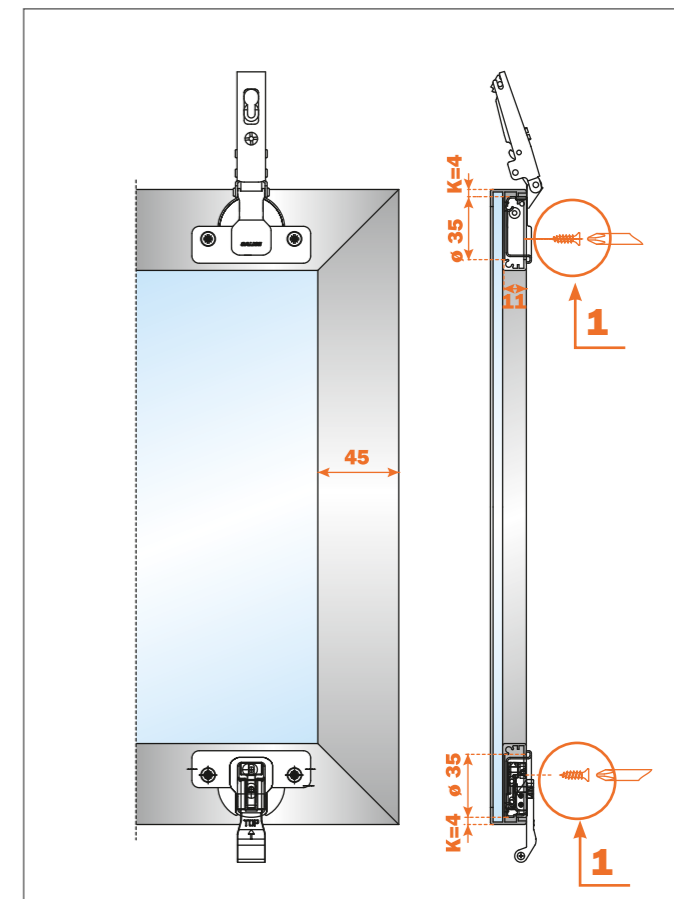
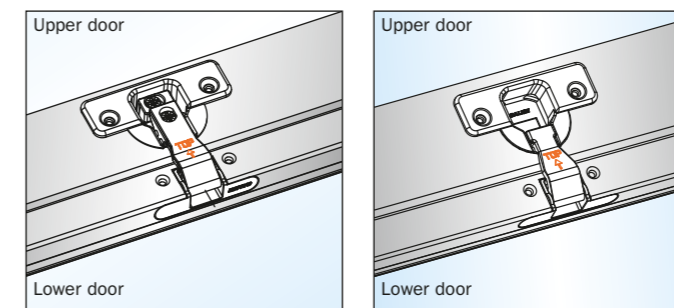

Drilling pattern for the lower wooden door

Available fixing systems for the hinge cup:

- A** = wood screw fixing, 48x6 mm drilling
- P** = wood screw fixing, 45x9.5 mm drilling
- U** = wood screw fixing, 52x5.5 mm drilling
- B** = dowel fixing, 48x6 mm drilling
- R** = dowel fixing, 45x9.5 mm drilling
- W** = dowel fixing, 52x5.5 mm drilling
- 6** = Rapido fixing, 48x6 mm drilling
- 7** = Rapido fixing, 45x9.5 mm drilling
- 2** = Rapido fixing, 52x5.5 mm drilling

D = sideways overlay

* Dimension is valid for cabinet heights 600, 660, 720 and 780 mm. For cabinets of different heights, please consult Salice customer service for the correct value.

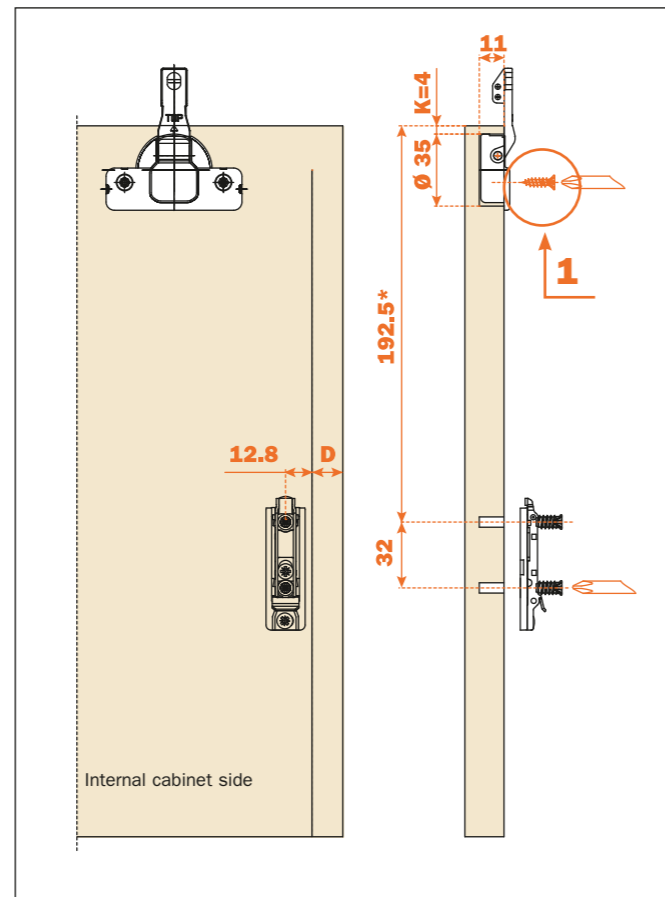
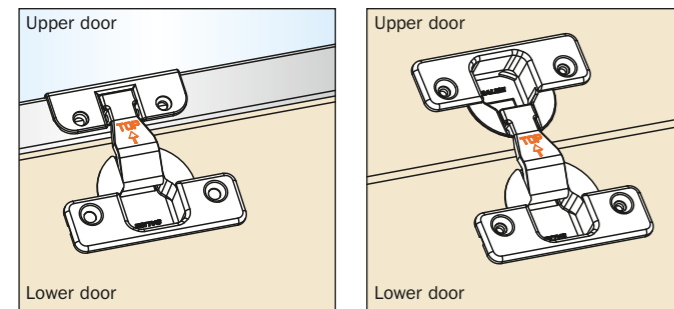

Drilling pattern for the lower alu-framed door - width min. 45 mm

Available fixing systems for the hinge cup:

- A** = wood screw fixing, 48x6 mm drilling
- P** = wood screw fixing, 45x9.5 mm drilling
- U** = wood screw fixing, 52x5.5 mm drilling

D = sideways overlay

* Dimension is valid for cabinet heights 600, 660, 720 and 780 mm. For cabinets of different heights, please consult Salice customer service for the correct value.

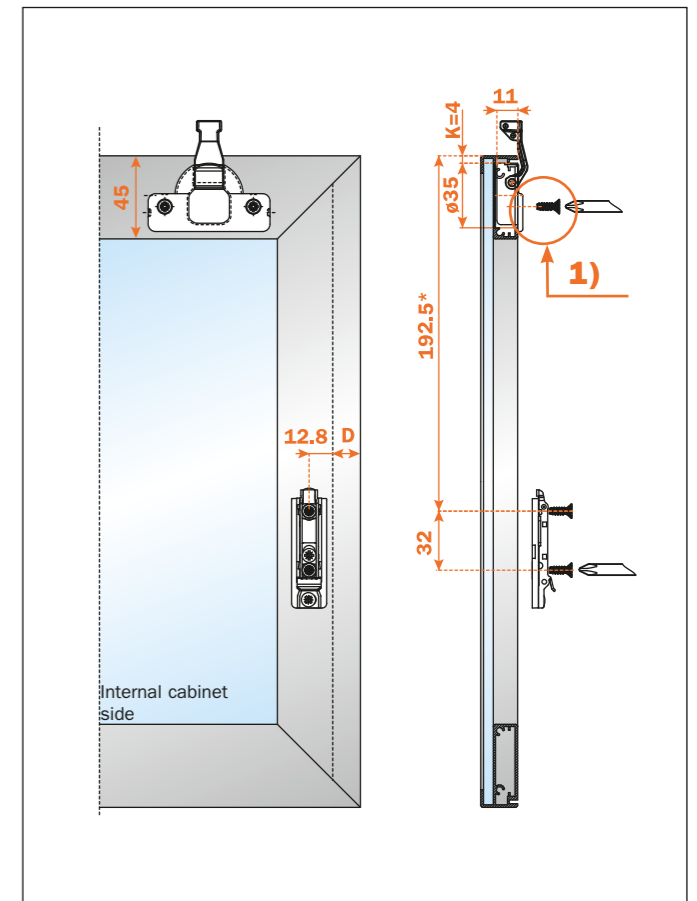
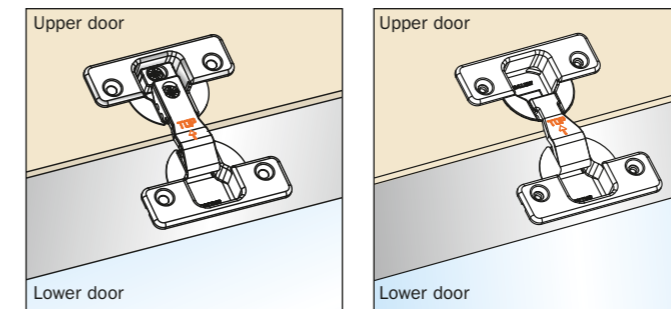

Drilling pattern for the lower alu-framed door width min. 17 mm, max. 24 mm

For alu-framed door, fix the mounting plate to the appropriate adapter.

D = sideways overlay

* Dimension is valid for cabinet heights 600, 660, 720 and 780 mm. For cabinets of different heights, please consult Salice customer service for the correct value.

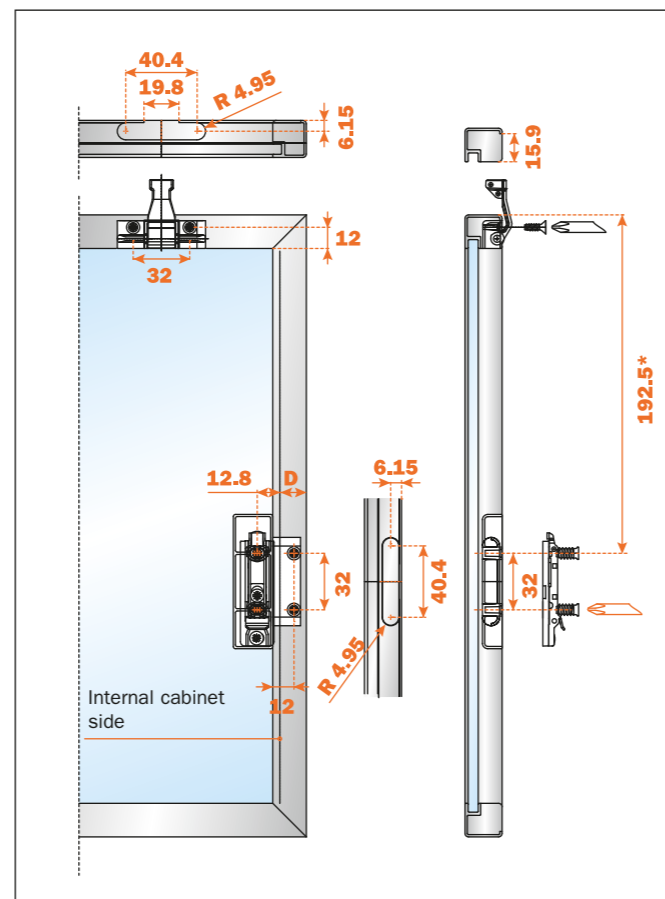
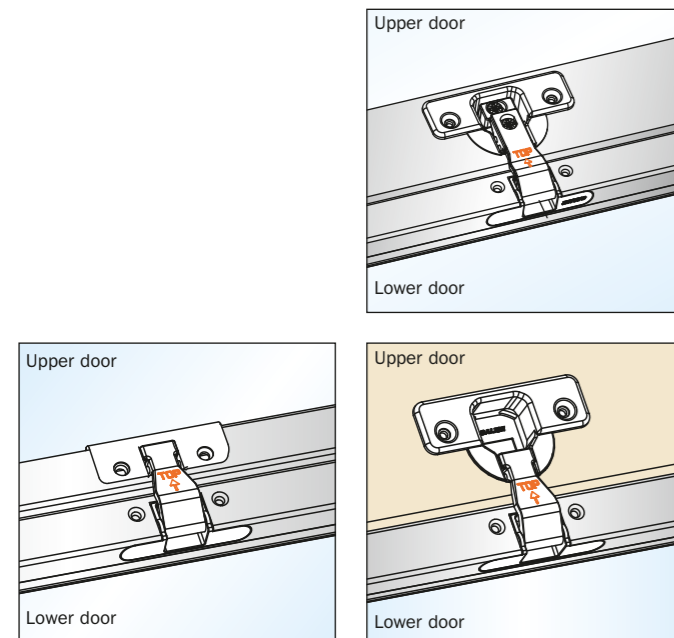

Fitting the doors to the cabinet

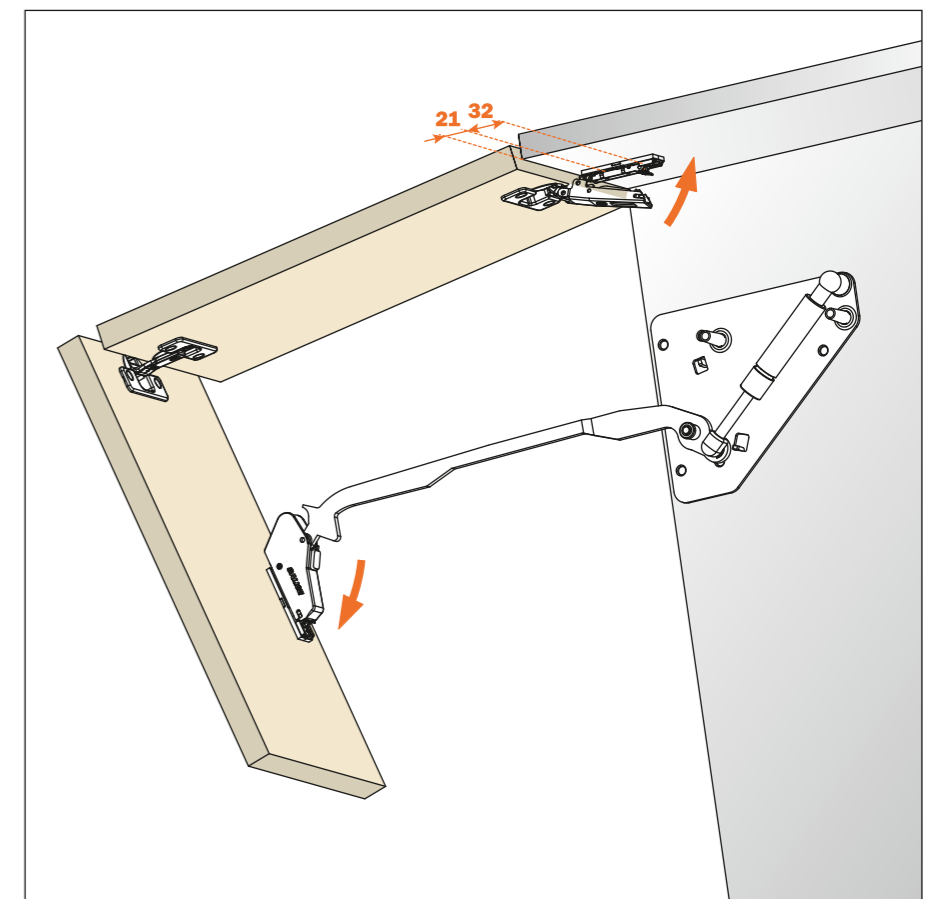

Installing the cover



Dimensions of the system

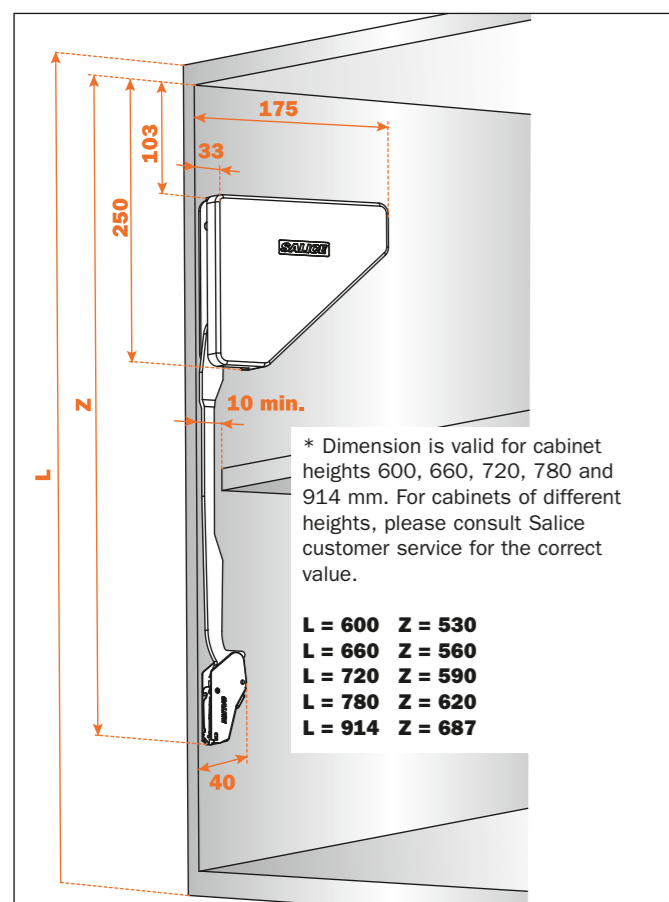

The shape of the lifting arm allows the use of shelves with a reduced depth of 10 mm only compared with the cabinet depth.

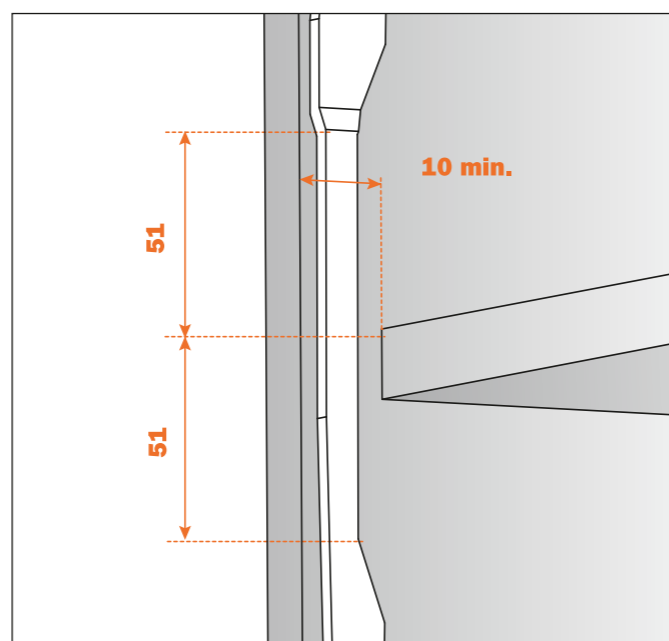

Replacement of the gas piston

Disconnect the lever arm from the lower door

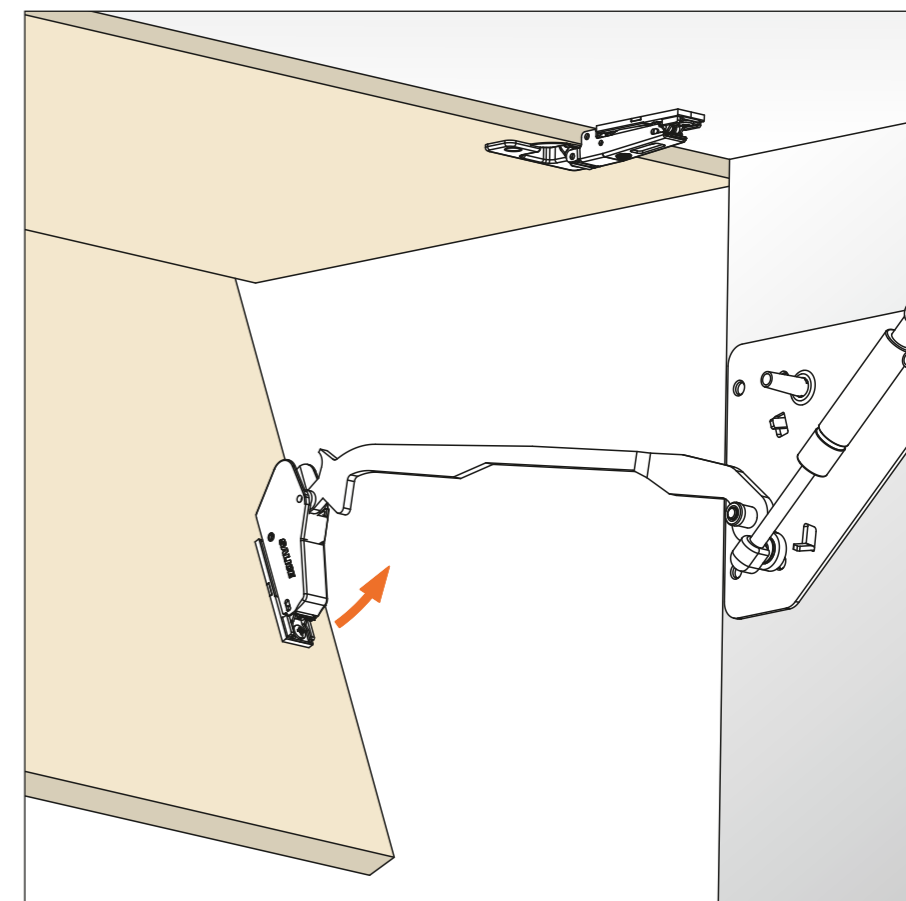

Disconnect the gas piston when it is fully extended

